

4K, WDR, IR, INTELLIGENT VANDAL



4K Fixed Lens Vandal

IPV4K28AIX

- > Fully Adheres to National Defense Authorization Act (NDA) Guidelines
- > Exceptional Video Quality with 4K (8MP), 3840 x 2160 Resolution
- > Super-Efficient H.265 Video Compression for Drastically Reduced Bandwidth and Storage Requirements
- > Powerful, Smart IR LED Lights for 0 Lux Night Time Operation up to 98 Feet
- > 2.8mm fixed, wide-angle lens; and Two-way Audio with Built-in Microphone
- > TRUE Day/Night and WDR functionality for all Lighting Conditions
- > Backlight Compensation, Corridor Mode, Defog and 3D DNR (Digital Noise Reduction)
- > Triple Video Streams; ONVIF Profile S Compliant and Built-in Micro-SD Card Slot enables local storage up to 256GB
- > Intelligent perimeter protection such as cross line and intrusion, with smart intrusion prevention technology for significantly reduced false alarms when focusing on humans and motor vehicles; and includes People Flow Counting and Crowd Density Monitoring
- > 3-Way Axis, IP67 Weather and IK10 Vandal Resistant Housing
- > PoE & 12VDC Power Options
- > Supported by uniview tec Guard Station Software and Guard Viewer Mobile App's for iPhone and Android Device

www.univiewtechnology.com



UVT70320124-00

Specifications

| Camera | | | | |
|-------------------------------|---|-------------|---------------|--------------|
| Sensor | 1/2.7" 4K (8MP), progressive scan CMOS | | | |
| Minimum illumination | Color: 0.003 lux (F1.6, AGC ON); 0 lux with IR on | | | |
| True Day / Night | IR-cut filter with auto switch (ICR) | | | |
| Shutter | Auto / Manual, 1 ~ 1/100000s | | | |
| Adjustment angle (3-way Axis) | Pan: 3° ~ 330°; Tilt: 0° ~ 68°; Rotate: 3° ~ 360° | | | |
| WDR | 120dB | | | |
| S/N | >52dB | | | |
| Lens | | | | |
| Lens | 2.8mm @ F1.6 | | | |
| Iris | Fixed | | | |
| Field of View (H) | 112.4° | | | |
| Field of View (V) | 60.1° | | | |
| Field of View (O) | 146.1° | | | |
| DORI | | | | |
| DORI Distance | Detect (m) | Observe (m) | Recognize (m) | Identify (m) |
| | 84 | 33.6 | 16.8 | 8.4 |
| Illuminator | | | | |
| IR Range | Up to 30m (98ft) IR range | | | |
| Wavelength | 850nm | | | |
| IR On/Off Control | Auto/Manual | | | |
| Video | | | | |
| Video Compression | Ultra 265, H.265, H.264, MJPEG | | | |
| H.264 code profile | Baseline profile, Main profile, High profile | | | |
| Frame Rate | Main Stream: 8MP (3840 x 2160), Max 20fps; 5MP (2880 x 1620), Max 30fps; 4MP (2560 x 1440), Max 30fps; 1080P (1920 x 1080) Sub Stream: 1080P (1920 x 1080), Max 30fps; 720P (1280 x 720) Max 30fps; D1 (720 x 576), Max 30fps; 640 x 360, Max 30fps; 2CIF (704 x 288), Max 30fps; CIF (352 x 288), Max 30fps Third Stream: D1 (720 x 576), Max 30fps; 640 x 360, Max 30fps; 2CIF (704 x 288), Max 30fps; CIF (352 x 288), Max 30fps | | | |
| Video Bit Rate | 128 Kbps~16 Mbps | | | |
| U-code | Support | | | |
| OSD | Up to 8 OSDs | | | |
| Privacy Mask | Up to 4 areas | | | |
| ROI | Up to 8 areas | | | |
| Video Stream | Triple | | | |

| Image | |
|----------------------------|--|
| White Balance | Auto / Outdoor / Fine Tune / Sodium Lamp / Locked / Auto2 |
| Digital Noise Reduction | 2D / 3D DNR |
| Smart IR | Support |
| Flip | Normal / Vertical / Horizontal / 180° / 90°Clockwise / 90°Anti-clockwise (Corridor) |
| Dewarping | Support |
| HLC | Support |
| BLC | Support |
| Defog | Digital Defog |
| Intelligent Analytics | |
| Smart Intrusion Prevention | Support false alarm filtering: Cross Line detection, Intrusion detection, Enter Area detection, Leave Area detection |
| Statistical Analysis | People counting, support people flow counting and crowd density monitoring |
| Recognition | Face capture |
| Intrusion Events | |
| Basic Detection | Motion detection, Ultra motion detection, tampering alarm, audio detection |
| General Function | Watermark, IP address filtering, tampering alarm, alarm input, alarm output, access policy, ARP protection, RTSP authentication, user authentication |
| Audio | |
| Audio Compression | G.711U, G.711A |
| Audio Bitrate | 64 Kbps |
| Two-way audio | Support |
| Suppression | Support |
| Sampling Rate | 8KHZ |
| Storage | |
| Edge Storage | Micro SD, up to 256GB |
| Network Storage | ANR |
| Network | |
| Protocols | IPv4; IPv6; IGMP; ICMP; ARP; TCP; UDP; DHCP; RTP; RTSP; RTCP; RTMP; DNS; DDNS; NTP; FTP; UPnP; HTTP; HTTPS; SMTP; SSL/TLS; 802.1x; SNMP; PPPoE |
| Compatible Integration | ONVIF (Profile S, Profile G, Profile T), API |
| User/Host | Up to 32 users. 3 user levels: administrator, common user and operator |
| Security | Password protection, Strong password, HTTPS encryption, Export operation logs, Basic and digest authentication for RTSP, Digest authentication for HTTP, TLS 1.2, WSSE and digest authentication for ONVIF |
| Client | Guard Station, Guard Viewer |
| Web Browser | Plug-in required live view: IE 10 and above, Chrome 45 and above, Firefox 52 and above, Edge 79 and above; Plug-in free live view: Chrome 57.0 and above, Firefox 58.0 and above, Edge 16 and above |
| Interface | |
| Audio I / O | Input: impedance 35kΩ; amplitude 2V [p-p]; Output: impedance 600Ω; amplitude 2V [p-p] |
| Alarm I / O | 1 / 1 |

| | |
|---------------------------|--|
| Built-in Mic | Support |
| Network | 1 * RJ45 10M/100M Base-TX Ethernet |
| General | |
| Power | DC 12V±25%, PoE (IEEE 802.3af); Power consumption: Max 6W |
| Power Interface | Ø 5.5mm coaxial power plug |
| Dimensions (Ø × H) | Ø 109x 83mm (Ø 4.3 x 3.3") |
| Weight | 0.43kg (0.99lb) |
| Working Environment | -30°C ~ 60°C (-22°F ~ 140°F), Humidity: ≤95% RH (non-condensing) |
| Surge Protection | 4KV |
| Conformity Certifications | IP67, IK10, CE, FCC |

Dimensions

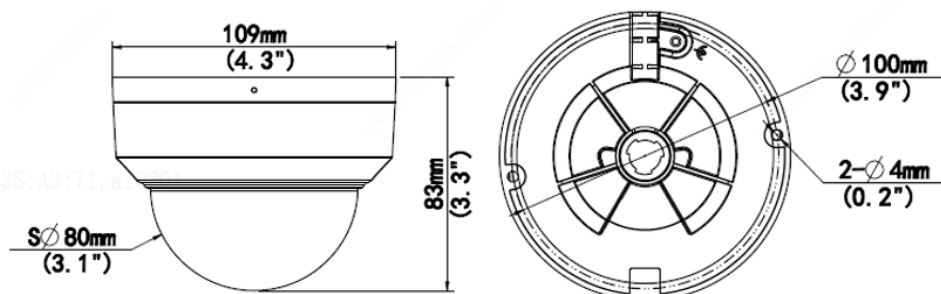

Accessories

See Camera Accessories Guide