

## **4MP, TRUE DAY/NIGHT, WDR, IR TURRET DOME**



*Fixed Lens Turret Dome*

### **IPT428BX**

- > Fully Adheres to National Defense Authorization Act (NDAA) Guidelines
- > Exceptional Video Quality with 4MP, 2688 x 1520 Resolution
- > Super-Efficient H.265 Video Compression for Drastically Reduced Bandwidth and Storage Requirements
- > Powerful, Smart IR LED Lights for 0 Lux Night Time Operation up to 98 Feet
- > 2.8 fixed lens
- > TRUE Day/Night and WDR functionality for all Lighting Conditions
- > Backlight Compensation, Defog and 3D DNR (Digital Noise Reduction)
- > One-Way Audio w/ built-in Microphone
- > Triple Video Streams and ONVIF Profile S Compliant
- > Powerful Video Analytics such as Intrusion, Tampering, Audio and Human Body Detection
- > IP67 Weather Resistant Housing and PoE & 12VDC Power Options
- > 3-Way Axis and Optional Wall, Junction Box and Pole Mounts Available
- > Supported by uniview tec Guard Station Software and Guard Viewer Mobile App's for iPhone and Android Devices

## Specifications

Camera	
Sensor	1/3", progressive scan , 4 megapixel, CMOS
Lens	2.8mm @ F2.0
Angle of View (H x V)	107.8° x 57.0°
Shutter	Auto/Manual, 1/6 ~ 1/100000 s
Minimum Illumination	Color: 0.01 Lux (F2.0, AGC ON); 0 Lux with IR
Day/Night	IR-cut filter with auto switch (ICR)
Digital noise reduction	2D/3D DNR
IR LED Range & Wavelength	Up to 30m (98 ft) IR range; 850nm
WDR	120dB
Video Compression & Bit Rate	Ultra 265, H.265, H.264, MJPEG; 128 Kbps ~ 16 Mbps
H.264 code profile	Baseline profile, Main Profile
Maximum Frame Rate / Stream	Main: 4MP (2688 x 1520)@ 30fps; or (2560 x 1440) @30fps; or 3MP (2304 x 1296) @ 30fps or 1920 x 1080 @ 30fps Sub: 720p (1280 x 720) @ 30fps Third Stream: D1 (704 x 576) @ 30fps
HLC, BLC, Defog, Flip, Dewarping	Supported
OSD, Privacy Mask, Motion Detection & ROI	Up to 4 areas
Network	
Protocols	IPv4, IGMP, ICMP, ARP, TCP, UDP, DHCP, RTP, RTSP, RTCP, DNS, DDNS, NTP, FTP, UPnP, HTTP, HTTPS, SMTP, SSL
Compatible Integration	ONVIF (Profile S, Profile G, Profile T), API
Network	RJ45, 10M/100M Base-T X Ethernet
Behavior Video Analytics	Intrusion, Human Body Detection, Motion, Tampering and Audio Detection
General	
Power	12 VDC +/- 25%, PoE (IEEE802.3 af); Power consumption: Max 5.5W
Audio I/O & Compression	1 / 0, w/ built-in Microphone; G711
Dimensions (Ø x H) & Weight	Ø118 x 96 mm (Ø4.6 x 3.8"); 0.33kg (0.73lb)
Operating Temperature & Humidity	-30°C ~ +60°C (-22°F ~ 140°F); Humidity: 10%~95% RH (non-condensing)
Conformity Certifications	IP67, CE, FCC

## Dimensions

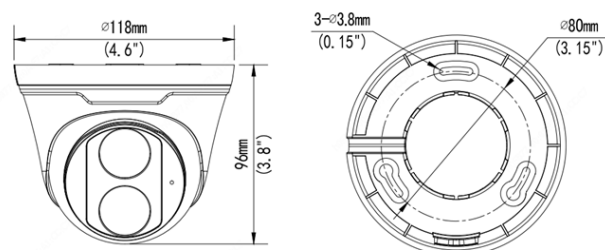

## Accessories

See Camera Accessories Guide